

- GENERAL NOTES:**
- All dimensions and existing services positions are to be verified on site by the contractor prior to starting the works.
 - All accepted safe digging practices and safe methods of working are to be employed during the installation of the structure.
 - The engineer is to be notified immediately of any discrepancies between the information shown and that found on site.
 - Workmanship and material are to comply with current Building Regulations, British Standards, Eurocodes, and codes of practice (relevant to the construction industry) and good building practice.
 - The contractor is entirely responsible for the method of working, temporary supports and structural integrity of this structure and that of any adjacent structures or services that are within influencing distance of the works being carried out.
 - All proprietary items to be fixed in accordance with manufacturers instructions and specifications.
 - All works to be carried out to approved risk assessments and method statements.
 - All existing services positions are to be verified on site by the contractor prior to starting the works.
 - Any organic matter, wet, dusty, loose or deteriorated soft spots to be removed and replaced with fully consolidated HA type sub-base to the required level or lean mix concrete.
 - Slab not to be loaded for a min period of 7 days.
 - Slab to be cast off 1200 gauge visqueen membrane or similar approved.
 - Concrete to be grade C40/50 in accordance with BS5500.
 - Concrete surface to be cured using Farcure 'Concure WB' applied as per manufacturers instructions. Slab surface to be smooth trowel finish.
 - Reinforcement to be grade BS500B or BS500C conforming to BS4449: 2005.
 - Bar schedule and bending to conform to BS8666.
 - Minimum cover 55mm to any concrete face, proprietary approved spacers to be utilised.
 - Minimum 400mm lap length for 10mm bars, 500mm for 12mm bars.
 - Maximum spacing of reinforcing bars to be 100mm c/c.
- FOSSROC
Tel: 01827 262 222
VISOUREN
Tel: 08453024756
- DESIGN BASED UPON AN ALLOWABLE SAFE BEARING PRESSURE OF 100 kN/m²**

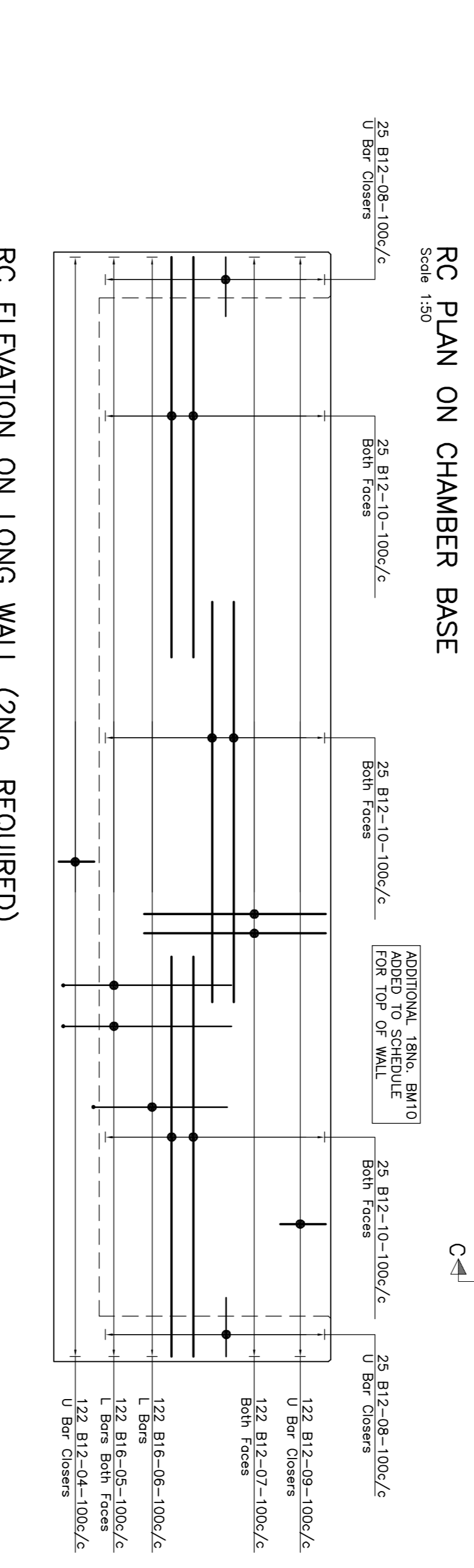
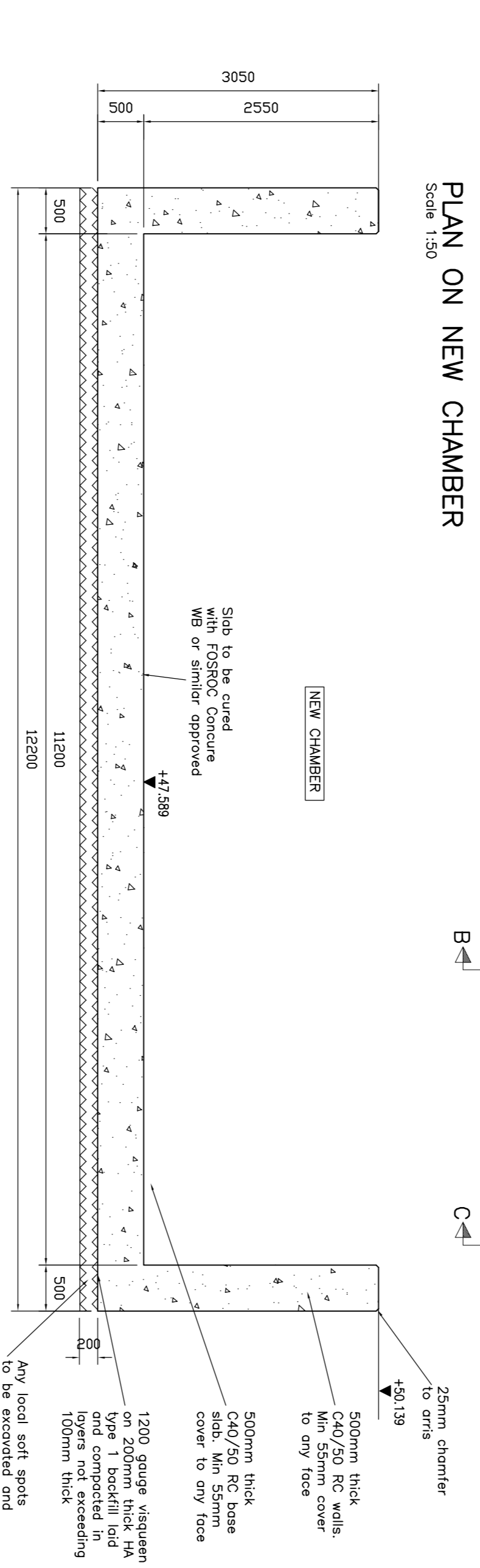

PROPOSED CHAMBER (REV D)

MEMBER	NO.	TYPE	SECTION	LENGTH	AREA	PERIMETER	WEIGHT	STRENGTH
BASE	01	B12	1	500	500	4890	0.4890	4890
BASE	02	B12	1	570	570	4400	0.4400	4400
BASE	03	B12	1	184	184	1929	0.1929	345
BASE	04	B12	1	244	244	1950	0.1950	390
BASE	05	B16	1	728	728	8829	0.8829	1550
BASE	06	B16	1	364	364	4430	0.4430	800
WALLS	07	B12	1	259	259	2600	0.2600	450
WALLS	08	B12	4	50	800	4424	0.4424	800
WALLS	09	B12	1	364	364	4430	0.4430	800
WALLS	10	B12	1	318	318	4400	0.4400	800
WALLS	11	B12	1	218	218	2700	0.2700	450
WALLS	12	B12	4	3	12	1200	0.1200	650
SLAB	13	B12	1	100	100	3150	0.3150	1400
SLAB	14	B12	1	70	70	3125	0.3125	1400
SLAB	15	B12	1	16	16	2800	0.2800	1400
SLAB	16	B12	1	24	24	1400	0.1400	1400
CHAMER	17	B12	1	450	450	1400	0.1400	250

ALL REINFORCING DIMENSIONS ARE IN ACCORDANCE WITH BS4666 * SPECIFIED TO THE NEAREST 5MM

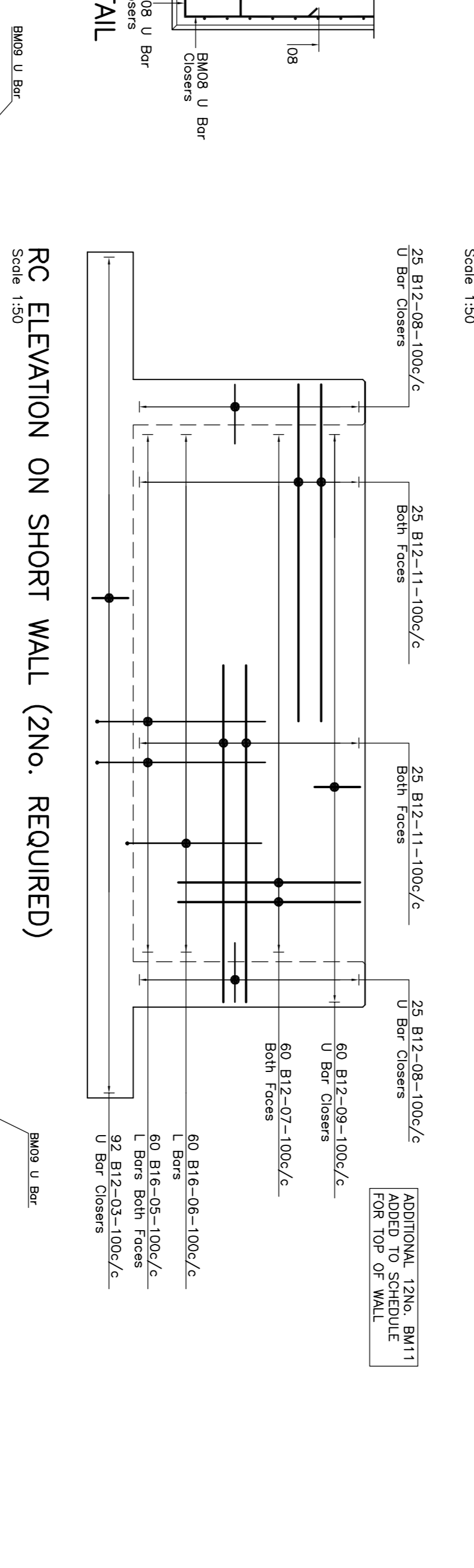
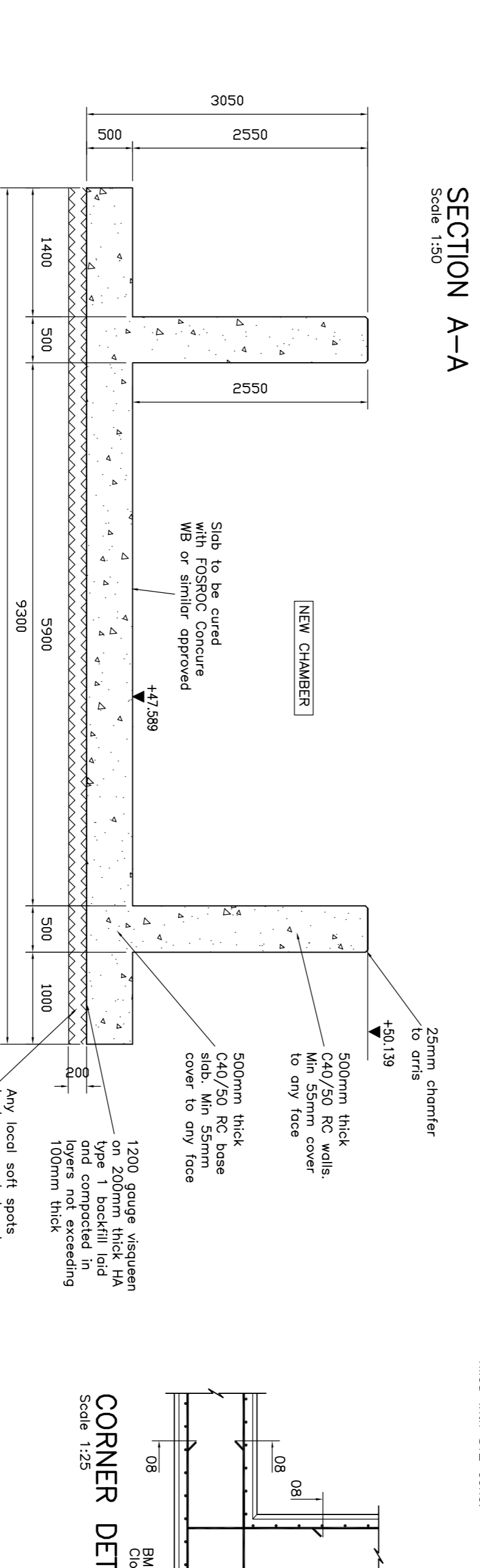

DESIGNED CONCRETE SPECIFICATION FOR PLANTING
(55 mm nominal cover)
The concrete shall be produced in accordance with BS5500-2.

Compressive strength class: C40/50
Minimum water/cement ratio: 0.4
Minimum cement/combination content: 380 kg/m³
SPECC LA (IB-S-IB-V) IIA+SR IIB IIB+SR (OC-1)
Maximum aggregate size 20 mm
Chloride content class: CC-40
Consistence class: S3

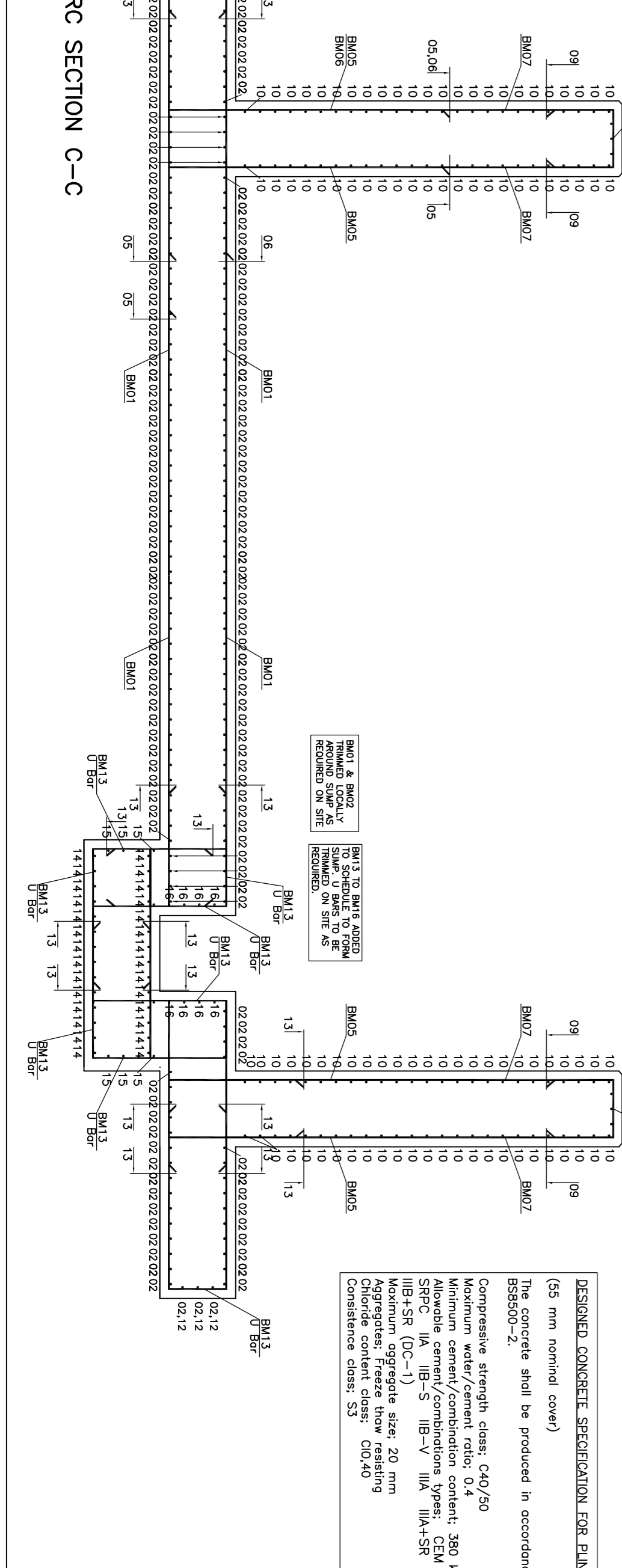
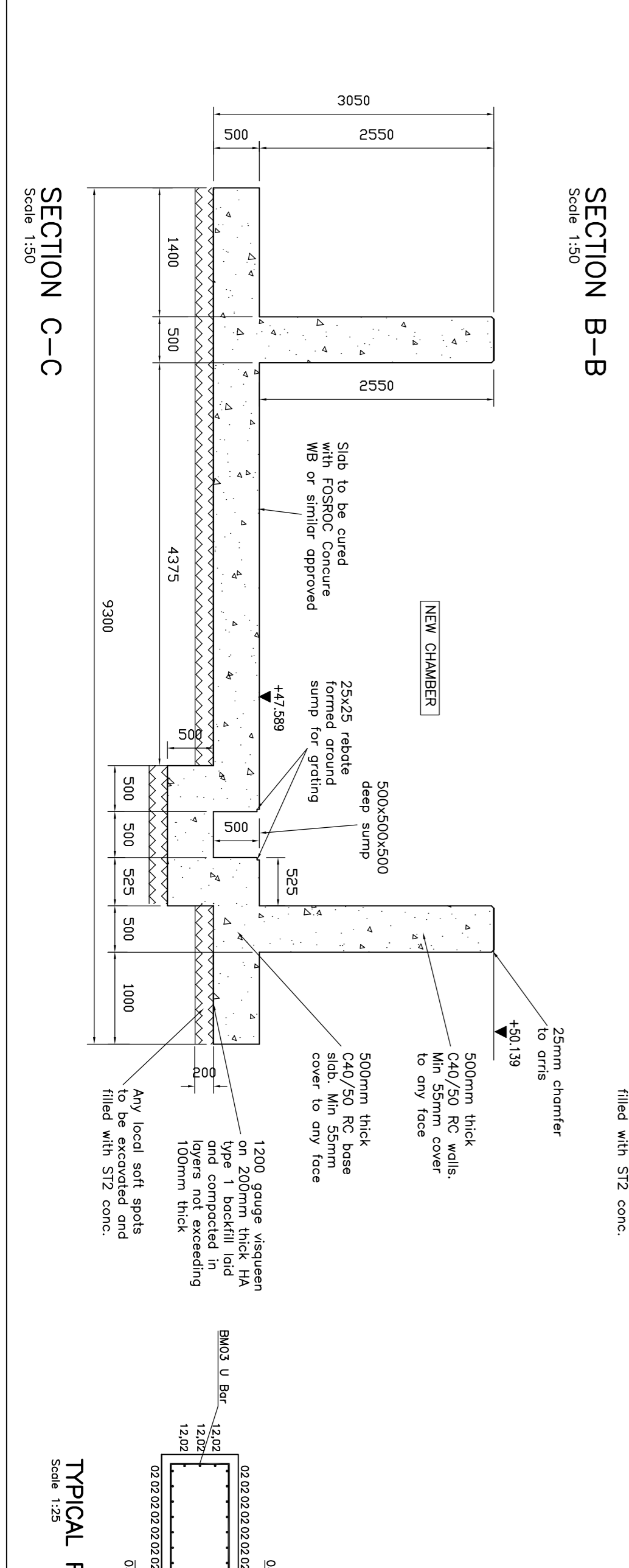

T&S Design Services
24 POPPERFIELD COTTAGE, PRESTON, PR4 0HR
Tel: 07974 772 456
Email: info@tandsdesignservices.co.uk

PREVIEW ONLY

REV	DATE	BY
AS SHOWN		